



CELSITE® , SURECAN®
ACCESS PORT SYSTEMS, ACCESSORIES AND
NON-CORING PORT NEEDLES

CELSITE®, SURECAN®, ACCESS PORT SYSTEMS, ACCESSORIES AND NON-CORING PORT NEEDLES

ACCESS PORT SYSTEMS

3 IMPLANTATION SITES

ACCESS PORT SYSTEMS FOR VENOUS ACCESS

- 4 CELSITE® SAFETY
Venous access ports for extended flexibility without compromise on safety
 - 6 CELSITE® EPOXY
Premium venous access ports with special compact port design
 - 8 CELSITE® DISCREET
Venous access ports with unique design for better cosmetic results
 - 10 CELSITE® DOUBLE PORT
Specialized venous access ports with two separated port chambers
-

ACCESS PORT SYSTEMS FOR SPINAL OR EPIDURAL ACCESS

- 11 CELSITE® SPINAL
For spinal administration of pain relieving drugs
-

ACCESS PORT SYSTEMS FOR PLEURAL AND PERITONEAL ACCESS

- 12 CELSITE® DRAINAPORT
For intra-peritoneal administration of chemotherapy or drainage of malignant ascites

CHARACTERISTICS, MRI, CECT

- 13 CELSITE®
MR Compatibility and high pressure resistance
-

SAFETY ACCESS PORT NEEDLES

- 14 SURECAN® SAFETY II
High pressure resistant non-coring safety needle for access ports
-

ACCESS PORT NEEDLES

- 16 WINGED SURECAN®
High pressure resistant non-coring safety needle for access ports
 - 17 ANGLED SURECAN®
Non-coring port needle for short term infusions
 - 17 STRAIGHT SURECAN®
Non-coring needle for bolus injections or flushing of access ports
-

18 ACCESSORIES

ACCESS PORT SYSTEMS

IMPLANTATION SITES

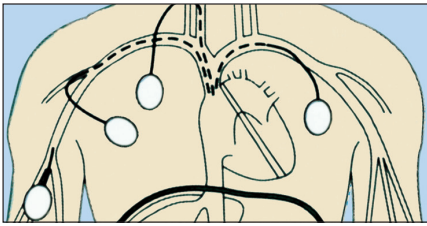

Venous access for repeated intra-venous administration of, for example, chemotherapy, antibiotics and anti-viral drugs, total parenteral nutrition (TPN), blood sampling or transfusion

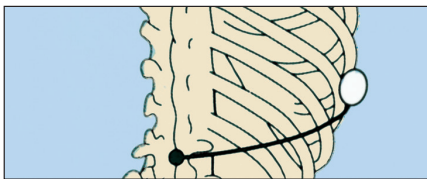

Epidural or intra-thecal access for spinal administration of pain relieving drugs



Peritoneal access for loco-regional chemotherapy and (i. e. with Drainaport®) for hydration and drainage of malignant ascites

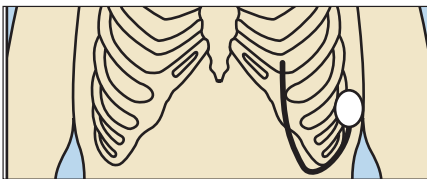

Pleural access for drainage of malignant pleural effusion (MPE)

ACCESS PORT FOR VENOUS ACCESS

Celsite® Safety

Venous access ports for extended flexibility without compromise on safety

Celsite® Safety is intended to be used in any condition that requires mid to long-term intermittent or continuous central venous infusions.

The anatomic design with a low profiled nose simplifies the insertion and allows the creation of a small port pocket to minimise the trauma.

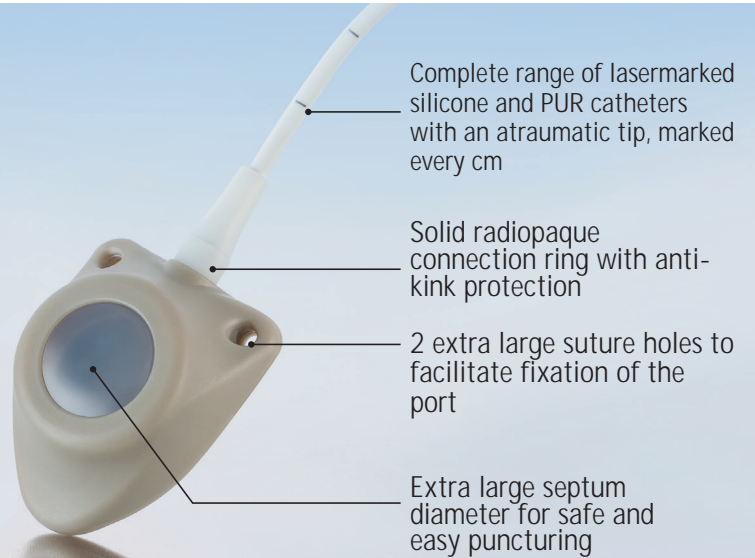

PEEK and titanium combination for maximum safety

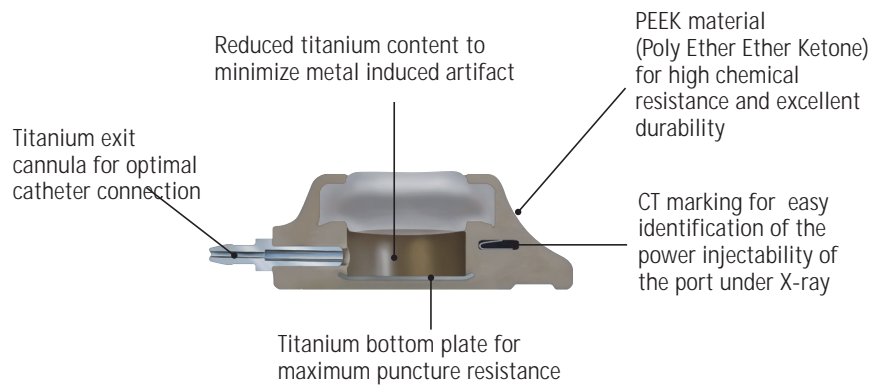

High pressure resistant and CT Marked

Celsite® Safety is resistant to high pressure injection up to 325psi (22.4bar). The radiopaque CT marking enables identification of the port in the X-ray image.



Safety Port Needle and Safety Puncture Needle with Echogenic Tip





Catheter	OD (F / mm)	ID (mm)	Length (mm)	Flow rate* (ml/min)		Recommended maximum flow rates (mL/s) Contrast media at 37°C (325 psi = 22.4bar)**						Implantation technique	Type	Reference	Accesso- ries see pg 18
						Viscosity 5.8 mPa.s (cP)			Viscosity 11.4 mPa.s (cP)						
						19G	22G	22G	20G	19G	22G				
Standard															
Silicone	6.5 / 2.2	1.1	500	26	10	2	5	5	2	5	5	Seldinger	SST601F	4437603	7
Silicone	8.5 / 2.8	1.2	500	34	11	2	5	5	2	5	5	Seldinger	SST601L	4437612	7
Silicone	10 / 3.2	1.6	500	48	12	2	5	5	2	5	5	Seldinger	SST601G	4437620	7
PUR	6.5 / 2.1	1.4	500	37	12	2	5	5	2	5	5	Seldinger	SST601P	4437607	7
PUR	8.5 / 2.8	1.6	500	48	12	2	5	5	2	5	5	Seldinger	SST601H	4437617	7
Small															
Silicone	6.5/2.2	1.1	500	26	10	2	5	5	2	5	5	Seldinger	SST605F	4437803	7
Silicone	8.5/2.8	1.2	500	34	11	2	5	5	2	5	5	Seldinger	SST605L	4437817	7
Silicone	10 / 3.2	1.6	500	48	12	2	5	5	2	5	5	Seldinger	SST605G	4437822	1
PUR	5/1.6	1.1	500	26	10	2	5	5	2	5	5	Seldinger	SST605C	4437800	7
PUR	6.5/2.1	1.4	500	37	12	2	5	5	2	5	5	Seldinger	SST605P	4437809	7
PUR	8.5/2.8	1.6	500	48	12	2	5	5	2	5	5	Seldinger	SST605H	4437813	7

Standard

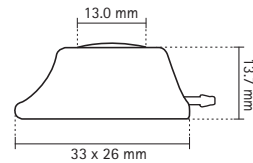

Material: Titanium | PEEK
Weight: 8g
Internal Volume: 0.5 mL

Small

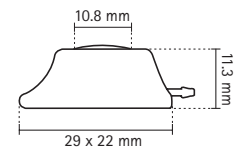

Material: Titanium | PEEK
Weight: 5g
Internal Volume: 0.3 mL

* Gravity flow rates established by gravity infusion of NaCl 0.9%, height 1m. Catheter length 40cm. According to ISO 10555-1.

** HP Flow rates determined according to ISO 10555-6 with a catheter of 20 cm and Surecan® Safety II. Flow rates are applicable to Winged / Angled Surecan®.

ACCESS PORT FOR VENOUS ACCESS

Celsite® Epoxy

Premium venous access ports for special compact port design

Celsite® Epoxy, Power injectable, Venous Access ports feature a low profile, large septum design

They are intended to be used for repeated, intravenous administration of, for example, chemotherapy, antibiotic and anti-viral drugs, parenteral nutrition, blood sampling or transfusion.

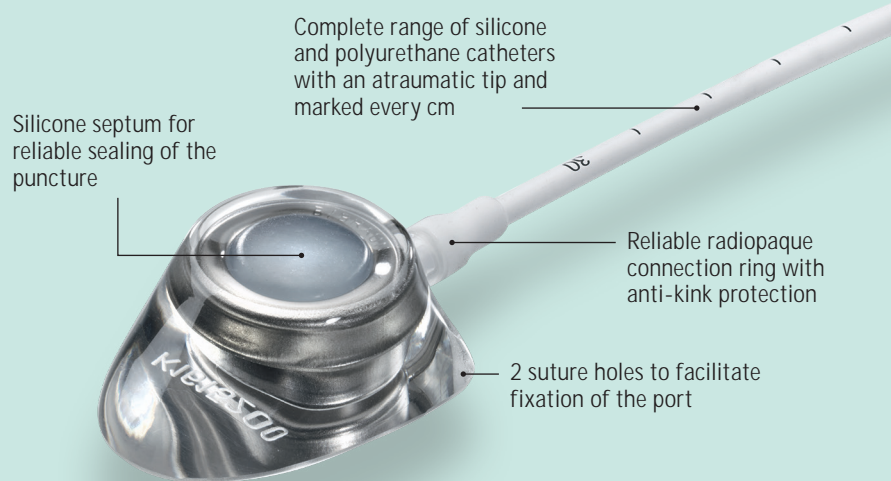

Highly compact design

Celsite® Epoxy ports have an extremely low profile and related to the total dimensions of the port a particularly large septum.



High pressure resistant

The complete range of venous Celsite® Epoxy ports is high pressure resistant up to 325 psi. This enables for power injections of contrast media in radiology, without the need for additional access and needlesticks.

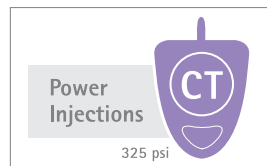

Radiopaque CT Marking

Celsite® Epoxy offers radiopaque CT marking. With CT marking it is possible to identify the port as high pressure resistant in the x-ray image.



Extended Portfolio

Available as extra small Brachial® and Babyport® sizes.





Catheter	OD (F / mm)	ID (mm)	Length (mm)	Flow rate* (ml/min)		Recommended maximum flow rates (mL/s Contrast media at 37°C (325 psi = 22.4 bar)**						Implantation technique	Type	Reference	Accessories see pg 18
						Viscosity 5.8 mPa.s (cP)			Viscosity 11.4 mPa.s (cP)						
						19G	22G	22G	20G	19G	22G				
Standard															
PUR	5 / 1.7	1.1	900	24	10	2	5	6	1	3	5	Braunule, Seldinger	ST201C	04432045	2
Silicone	6.5 / 2.2	1.1	800	26	10	2	6	7	1	4	5	Seldinger	ST201F	04430409	1
PUR	6.5 / 2.1	1.4	800	34	11	2	5	7	1	4	6	Seldinger	ST201P	04430417	1
PUR (high flow)	8.5 / 2.8	1.6	800	45	12	2	6	8	1	4	7	Seldinger	ST201H	04433149	1
Silicone	8.5 / 2.8	1.1	800	28	13	2	6	7	1	4	6	Seldinger	ST201	04430395	1
Silicone (high flow)	10 / 3.2	1.6	800	47	13	2	6	9	1	4	6	Seldinger	ST201G	04433807	1
Small															
Silicone	6.5 / 2.2	1.0	800	24	10	2	5	8	1	4	6	Seldinger	ST205	04430893	1
PUR	6.5 / 2.1	1.4	800	30	11	2	5	8	1	4	5	Seldinger	ST205P	04430894	1
Silicone	8.5 / 2.8	1.1	800	25	10	2	5	8	1	3	6	Seldinger	ST205L	04430895	1
PUR (high flow)	8.5 / 2.8	1.6	800	37	12	2	6	9	1	4	6	Seldinger	ST205H	04436806	1
Silicone***	6.5 / 2.2	1.0	800	24	10	2	5	8	1	4	6	Seldinger	ST215	04430143	1
Baby/Brachial															
PUR	4.5 / 1.5	0.8	800	12	7	2	4	-	1	3	-	Seldinger	Babyport®	04433742	4
PUR	5 / 1.6	1.1	700	22	10	2	5	-	1	4	-	Seldinger, OTW	Brachial	04433734	10
Silicone	6 / 2.0	1.2	600	24	10	2	5	-	1	4	-	Seldinger	Babyport® S	04433842	5

Celsite® Epoxy offers a wide range of Silicone and PUR catheters and three different port sizes, Standard, Small and Baby/brachial.

Standard

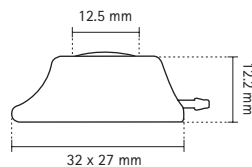

Material: Titanium | Epoxy
Weight: 8g
Internal Volume: 0.5 mL

Small

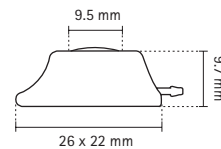

Material: Titanium | Epoxy
Weight: 5g
Internal Volume: 0.25 mL

Baby / Brachial

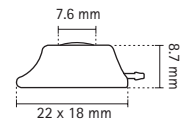

Material: Titanium | Epoxy
Weight: 3g
Internal Volume: 0.15 mL

* Gravity infusion of saline (0.9%) through a 22G respectively 19G needle from a height difference of 1 m and a catheter length of 40 cm. According to ISO 10551-1

** With a catheter of 20 cm and Surecan® Safety II. For countries under CE mark only.

*** With pre-connected catheter.

ACCESS PORT FOR VENOUS ACCESS

Celsite® Discreet

Venous access ports with unique design for enhanced port stability and better cosmetic results

Celsite® Discreet offers unique design and allows better cosmetic results for the patient.

- The low profile design with patented 90° connection provides a high level of discretion
- Also available in small size to facilitate implantation in paediatric and underweight patients
- MRI conditional, Latex, DEHP and PVC free
- With radiopaque "CT" marking.



Prevention of Port Flip

Patented 90° angle of the exit cannula reduces the risk of port flip and associated blockage due to catheter kinking

Better Cosmetic Results

The surgical incision can be made vertically and placed laterally following the subcutaneous traction lines.

High Pressure Resistant

The complete range of venous Celsite® Discreet ports is high pressure resistant up to 325 psi. This enables for power injections of contrast media in radiology, without the need for additional access and needlesticks.

Radiopaque CT Marking

Celsite® Discreet offers radiopaque CT marking. With CT marking it is possible to identify the port as high pressure resistant in the x-ray image.

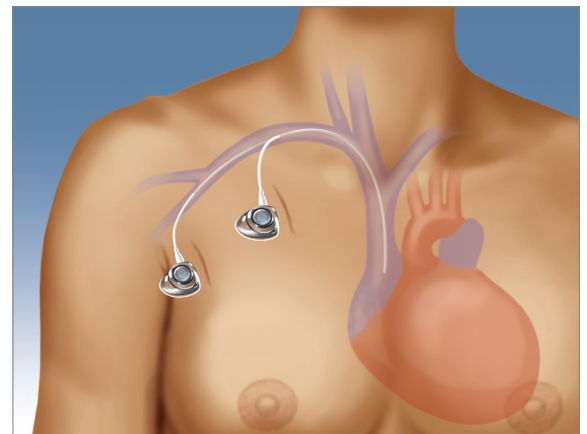

Standard and lateral placement of Celsite® Discreet with vertical incision.



CT-Marking of Celsite® Discreet

Catheter	Exit cannula	OD (F/mm)	ID (mm)	Length (mm)	Flow rate* (ml/min)		Recommended maximum flow rates (mL/s) Contrast media at 37°C (325 psi = 22.4 bar)**						Implantation technique	Type	Reference	Accessories see page 18
							Viscosity 5.8 mPa.s(cP)			Viscosity 11.4 mPa.s(cP)						
					19G	22G	22G	20G	19G	22G	20G	19G				
Standard																
Silicone	left	8.5/2.8	1.1	800	28	13	2	6	7	1	4	6	Seldinger	STL201L	04430144	1
Silicone	right	8.5/2.8	1.1	800	28	13	2	6	7	1	4	6	Seldinger	STR201L	04430145	1
PUR	left	8.5/2.8	1.6	800	45	12	2	6	8	1	4	7	Seldinger	STL201H	04440201	1
PUR	right	8.5/2.8	1.6	800	45	12	2	6	8	1	4	7	Seldinger	STR201H	04440202	1
Small																
Silicone	left	6.5/2.2	1.1	800	24	10	2	5	8	1	4	6	Seldinger	STL205F	04430146	1
Silicone	right	6.5/2.2	1.1	800	24	11	2	5	8	1	4	6	Seldinger	STR205F	04430147	1
PUR	left	6.5/2.1	1.4	800	30	11	2	5	8	1	4	5	Seldinger	STL205P	04440203	1
PUR	right	6.5/2.1	1.4	800	30	11	2	5	8	1	4	5	Seldinger	STR205P	04440204	1

Standard

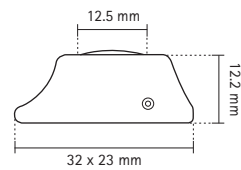

Material: Titanium | Epoxy
Weight: 7g
Internal Volume: 0.5 mL

Small

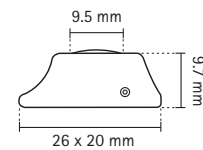

Material: Titanium | Epoxy
Weight: 4g
Internal Volume: 0.25 mL

* Gravity flow rates established by gravity infusion of NaCl 0.9%, height 1m. Catheter length 40cm. According to ISO 10555-1.

** With a catheter of 20 cm and Surecan® Safety II. For countries under CE mark only.

ACCESS PORT FOR VENOUS ACCESS

Celsite® Double Port

Specialized venous access ports with two separate port chambers and catheter lumens for simultaneous infusion

Power
Injections

325 psi



- For simultaneous infusion of e.g. incompatible drugs
- For infusion with high flow rates by using both lumina
- Administration of continuous infusion and bolus injection
- Alternating puncture sites
- Profiled shape to be easily placed in a small pocket
- Small size facilitates implantation in paediatric and underweight patients
- Off-set silicone catheter tip ensures that no mixing of drugs occurs at the catheter tip
- Available with radiopaque "CT" marking.



Catheter	OD (F/mm)	ID (mm)	Length (mm)	Flow rate* (ml/min)		Recommended maximum flow rates (mL/s) Contrast media at 37°C (325 psi = 22.4 bar)						Implantation technique	Type	Reference	Accessories see page 18	
						Viscosity 5.8 mPa.s (cP)			Viscosity 11.4 mPa.s (cP)							
				19G	22G	22G	20G	19G	22G	20G	19G					
Standard																
Silicone	10 / 3.2	1.2 x 2	800	32	11	2	5	8	1	4	6	Seldinger	ST401L	04430100	1	
Small																
Silicone	10 / 3.2	1.2 x 2	800	29	11	2	5	8	1	4	6	Seldinger	ST405L	04430101	1	



Standard

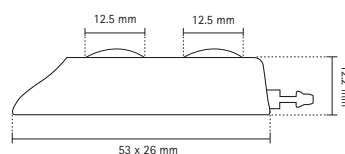

Material: Titanium | Epoxy
Weight: 14g
Internal Volume: 0.5 mL x 2

Small

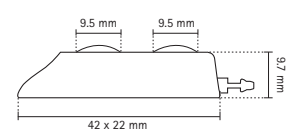

Material: Titanium | Epoxy
Weight: 7.5g
Internal Volume: 0.25 mL x 2

* Gravity infusion of saline (0.9%) through a 22G respectively 19G needle from a height difference of 1 m and a catheter length of 40 cm. According to ISO I0555-1

** With a catheter of 20 cm and Surecan® Safety II. For countries under CE mark only.

ACCESS PORTS FOR SPINAL OR EPIDURAL ACCESS

Celsite® Spinal

For spinal administration of pain relieving drugs

- For spinal administration of pain relieving drugs
- The catheter is tunneled under the skin to the access port, which is implanted at the base of the ribs
- Light weight and comfortable
- Profiled shape design facilitates insertion
- Integrated titanium filter prevents the passage of particles

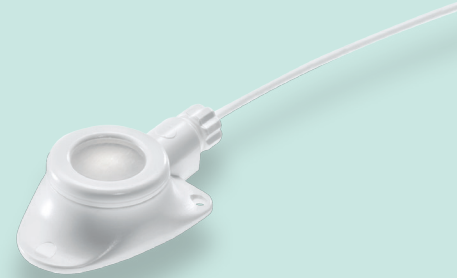
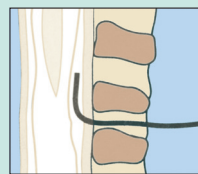
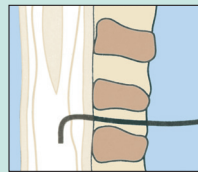
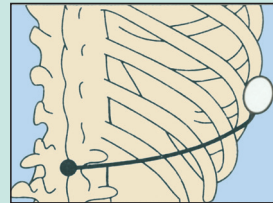

Catheter

Every Access Port kit contains 2 catheters:

- 1 multiperforated closed tip polyamide catheter (PA)
- 1 open tip polyurethane catheter (PUR) with a Teflon®-coated guide wire

Catheter	OD	OD (mm)	ID (mm)	Length (mm)	Flow rate* (ml/min)		Implantation technique	Type	Reference
					19G	22G			
Standard									
PUR and PA	19G	1.05	0.6	1000	3	3	spinal/epidural	ST304-19	04430096
PUR and PA	20G	0.86	0.45	1000	1	1	spinal/epidural	ST304-20	04430097

Accessory kit:

- Screw connector (2x)
- Spanner
- Anti-kink device (2x)
- Tunneling rod
- Winged Surecan® needle 20G x 20 mm
- Omnifix® syringe 10 mL
- Perican® Tuohy needle 16G (ST304-19) or Tuohy needle 18G (ST304-20)
- Perifix® 0.2 µm filter
- Scalpel size 10 and 11
- Sterican® needle 20G x 70 mm
- Perifix® LOR syringe
- Straight Surecan® 22G x 30 mm (2x)

Standard

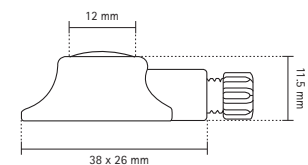

Material: Polysulphone | Titanium-Filter
 Weight: 6g
 Internal Volume: 0.33 mL

* Gravity infusion of saline (0.9%) through a 22G respectively 19G needle from a height difference of 1 m and a catheter length of 40 cm. According to ISO I0555-1

ACCESS PORT FOR PLEURAL AND PERITONEAL ACCESS

Celsite® Drainaport

For intra-peritoneal administration of chemotherapy, hydration, drainage of malignant ascites, or drainage of malignant pleural effusion

- For intra-peritoneal administration of chemotherapy, hydration, drainage of malignant ascites, or drainage of malignant pleural effusion
- Helps to avoid repeated, painful puncture for drainage
- Improves quality of life and is an easy and effective solution for home care treatment
- Celsite® DRAINAPORT can be implanted percutaneously or by surgical cut-down technique
- Catheter cuff** promotes tissue ingrowth to reduce infection risk and holds the catheter enabled in place
- Connection** is enabled with the radiopaque titanium connection ring
- Silicone septum** for reliable puncture
- Anatomic design** with delta shape profile, light weight and easy to suture
- Smooth, large and flexible **multiperforated silicone catheter** with 49 oval holes (Ø 1.1 x 1.6 mm) from the tip up to 20 cm to prevent blockage of the catheter and ensure efficiency.



Catheter	OD (F/mm)	ID (mm)	Length (mm)	Flow rate* (ml/min)		Implantation technique	Type	Reference
				19G	22G			
Standard								
Silicone	15/4.9	2.6	550	55	13	peritoneal / pleural	T203J-1	04430169

Accessories:

Every Access Port kit contains:

- 2 Straight Surecan® needles 22G x 33 mm

The implantation accessories kit AP16F can be ordered separately (Reference 4430493; see page 19).

Standard

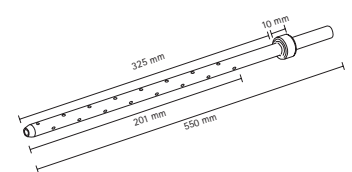
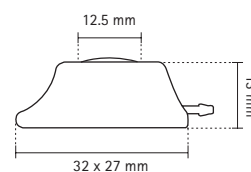

Material: Titanium | Epoxy
 Weight: 10g
 Internal Volume: 0.5 mL

* Gravity infusion of saline (0.9%) through a 22G respectively 19G needle from a height difference of 1 m and a catheter length of 40 cm. According to ISO 10555-1

MR COMPATIBILITY AND HIGH PRESSURE RESISTANCE

Celsite®

Power
Injections



325 psi



MR-Conditional

Non-clinical testing demonstrated that Celsite® Access Ports and Surecan® port needles (including Safety II and Ultrasite®) are MR Conditional. A patient with these devices can be scanned immediately after placement under the following conditions:

- Static magnetic field of 3-Tesla and 1.5-Tesla
- Maximum spatial gradient magnetic field of 710 Gauss/cm or less
- Maximum whole body averaged specific absorption rate (SAR) of 2.9 W/kg for 15 minutes of scanning

MR image quality may be compromised if the area of interest is in the exact same area or relatively close to the position of the devices. Therefore, optimization of MR imaging parameters to compensate for the presence of these devices may be necessary.

Please see instructions for use for general information and information on MRI-related heating.

Pressure Resistance

All venous Celsite® Access Ports with titanium chamber or a titanium plate are pressure resistant up to 325psi/ 22.4 bar (except for valved catheters and Celsite® Implantofix).

Please see instructions for use for detailed device information regarding high pressure injection.

Material

All Celsite® Access Ports are latex-, PVC- and DEHP-free. All Surecan® needles are latex- and DEHP-free.

**LATEX
FREE**

**PVC
FREE**

**DEHP
FREE**

SAFETY ACCESS PORT NEEDLES

Surecan® Safety II

High pressure resistant non-coring safety needle for access ports

Surecan® Safety II is the power injectable access port needle with an easy to use safety mechanism for minimized risk of needlestick injuries.

The small size and innovative design of Surecan® Safety II enables comfort for both clinicians and patients, either in hospital or for home care treatment.



User safety

Intuitive safety mechanism for reduced risk of needlestick injuries

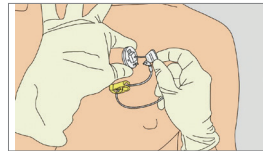

Patient comfort

Low profile and foam pad for better patient comfort



Handling

Flexible and ergonomic wings for reliable handling



Power injections

Suitable for power injections up to 325 psi

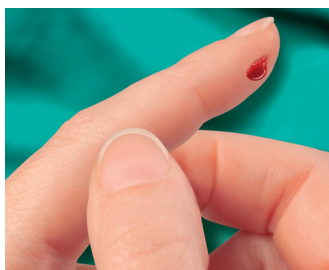
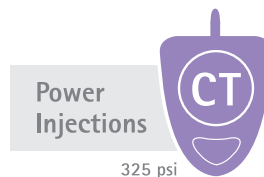

For more information on the risks and prevention of needlestick injuries:
www.safeinfusiontherapy.com

Surecan® Safety II non-coring safety needle

- Tubing length cannula to connector: 200mm



Size	Cannula diameter (mm)	Cannula length (mm)	Sales unit-pcs.	Reference
G 19	1.1	12	20	04447042
G 19	1.1	15	20	04447000
G 19	1.1	20	20	04447001
G 19	1.1	25	20	04447002
G 19	1.1	32	20	04447003
G 19	1.1	38	20	04447004
G 20	0.9	12	20	04447043
G 20	0.9	15	20	04447005
G 20	0.9	20	20	04447006
G 20	0.9	25	20	04447007
G 20	0.9	32	20	04447008
G 20	0.9	38	20	04447009
G 22	0.7	12	20	04447044
G 22	0.7	15	20	04447010
G 22	0.7	20	20	04447011
G 22	0.7	25	20	04447012
G 22	0.7	32	20	04447013

Surecan® Safety II non-coring safety needle with pre-connected Caresite® and Y-site

- Y-site configuration
- Tubing length Y-site to connector: 98 mm
- Tubing length cannula to Y-site: 105 mm
- Caresite® is a needle-free, positive pressure valve which reduces the risk of blood reflux



Size	Cannula diameter (mm)	Cannula length (mm)	Sales unit (pcs.)	Reference
G 19	1.1	12	20	04447057
G 19	1.1	15	20	04447045
G 19	1.1	20	20	04447046
G 19	1.1	25	20	04447047
G 19	1.1	32	20	04447048
G 19	1.1	38	20	04447049
G 20	0.9	12	20	04447058
G 20	0.9	15	20	04447050
G 20	0.9	20	20	04447051
G 20	0.9	25	20	04447052
G 20	0.9	32	20	04447053
G 22	0.7	12	20	04447059
G 22	0.7	15	20	04447054
G 22	0.7	20	20	04447055
G 22	0.7	25	20	04447056

Easy removal

- 1 Stabilise the needle base on the port
 - 2 Firmly pull the wings up until you hear a "Click"
- Green dot and audible click clearly indicate the safety mechanism was executed
 - Non-absorbant closed-cell foam pad of the patient plate
 - MR conditional, Latex and DEHP free

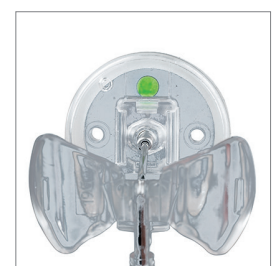
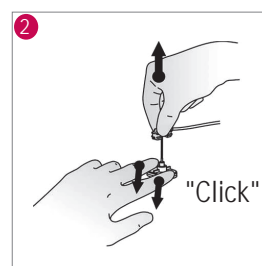
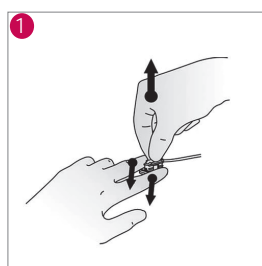

ACCESS PORT NEEDLES

Winged Surecan®

Winged Surecan® non-coring needle

- Use for long-term infusions
- High pressure resistant up to 325 psi (22.4 bar)
- Flexible wings for relieved puncture and fixation
- Latex- and DEHP-free
- Extension tubing with clamp
- Tubing length cannula to connector: 200mm



Size	Cannula diameter (mm)	Cannula length (mm)	Sales unit-pcs.	Reference
19G	1.1	15	15	04448286
19G	1.1	20	15	04448294
19G	1.1	25	15	04448308
20G	0.9	15	15	04448332
20G	0.9	20	15	04448340
20G	0.9	25	15	04448359
20G	0.9	30	15	04448367
22G	0.7	12	15	04448375
22G	0.7	15	15	04448383
22G	0.7	20	15	04448391
22G	0.7	25	15	04448405

Winged Surecan® non-coring needle with Y-site

- Use for long-term infusions
- Flexible wings for relieved puncture and fixation
- Latex- and DEHP-free
- Tubing length Y-site to connector: 98mm
- Tubing length cannula to Y-site: 105mm
- Y-site configuration



Size	Cannula diameter (mm)	Cannula length (mm)	Sales unit-pcs.	Reference
19G	1.1	20	15	04448430
19G	1.1	25	15	04448448
20G	0.9	15	15	04448472
20G	0.9	20	15	04448480
20G	0.9	25	15	04448499
22G	0.7	15	15	04448529
22G	0.7	20	15	04448537
22G	0.7	25	15	04448545
22G	0.7	30	15	04448553

ACCESS PORT NEEDLES

Angled Surecan® | Straight Surecan®

Angled Surecan® non-coring needle

- Use for short-term infusions
- Latex-, PVC- and DEHP-free

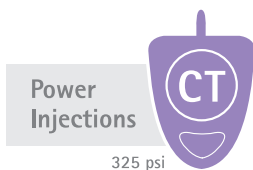

Size	Cannula diameter (mm)	Cannula length (mm)	Sales unit-pcs.	Reference
19G	1.1	15	50	04438000
19G	1.1	20	50	04439430
19G	1.1	25	50	04439406
20G	0.9	15	50	04439929
20G	0.9	20	50	04439937
20G	0.9	25	50	04439945
20G	0.9	35	50	04434862
22G	0.7	15	50	04439813
22G	0.7	20	50	04439821
22G	0.7	25	50	04439830
22G	0.7	35	50	04434870

Straight Surecan® non-coring needle

- Use for bolus injection or flushing of the Access Port
- Latex-, PVC- and DEHP-free



Size	Cannula diameter (mm)	Cannula length (mm)	Sales unit-pcs.	Reference
20G	0.9	40	100	04439953
20G	0.9	70	100	04439998
20G	0.9	90	100	04440000
22G	0.7	30	100	04439848
24 G	0.55	25	100	04439414

ACCESSORIES

Venous Accessories

Pieces	Kit designation	Implantation technique					
		Percutaneous					
		Seldinger		OTW	Seldinger / OTW	Seldinger/Braunule	
		Kit 1	Kit 12	Kit 3	Kit 13	Kit 2	
2	A	Straight Surecan® needles	22 G x 30 mm	22 G x 30 mm	22 G x 30 mm	22 G x 30 mm	22 G x 30 mm
1	B	Vein lifter	✓	✓	✓	✓	✓
1	C	Puncture needle	18 G x 70 mm	18 G x 70 mm	18 G x 70 mm	18 G x 70 mm	18 G x 70 mm
1		Splittocan needle					14 G x 80 mm
1	E	J guide wire with dispenser	0.035" x 50 cm	0.035" x 50 cm	0.035" x 70 cm	0.035" x 70 cm	0.035" x 50 cm
1	F	Dilator			6F x 100 mm	6F x 100 mm	
1	G	Tear-away introducer	L 180/140 mm	L 180/140 mm			L 180/140 mm
1	H	Tunnelling rod	✓	✓	✓	✓	✓
1	I	Omnifix luer syringe	10 mL	10 mL	10 mL	10 mL	10 mL
1	J	Winged Surecan® needle	20 G x 20 mm		20 G x 20 mm		20 G x 20 mm

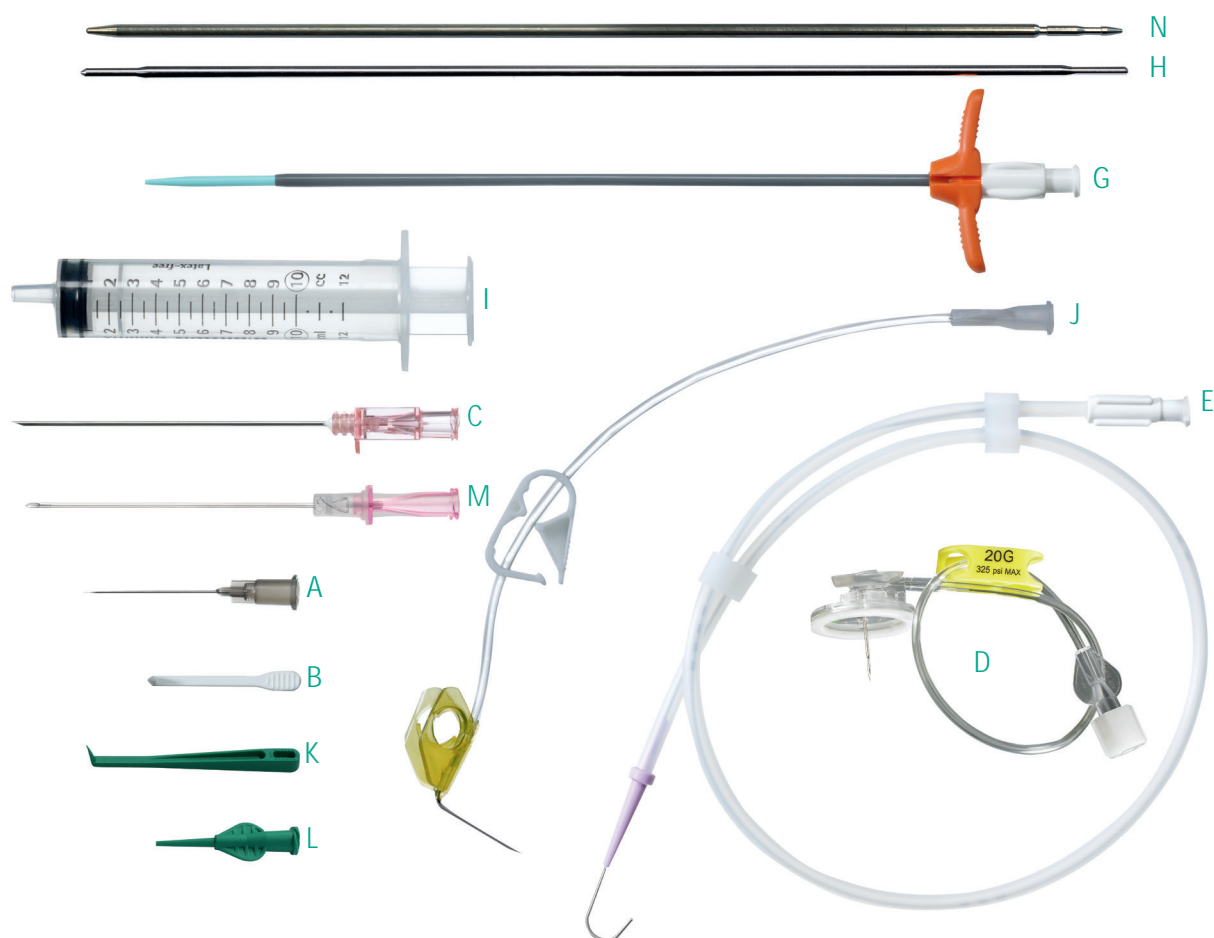

ACCESSORIES

VENOUS ACCESSORIES

		Implantation technique	Percutaneous			
			OTW	Seldinger		ECG
Pieces		Kit designation	Kit 10 (Brachial)	Kit 4 (Baby)	Kit 5 (Baby)	Kit 9
2	A	Straight Surecan® needles	22 G x 30 mm	22 G x 30 mm	22 G x 30 mm	22 G x 30 mm
1	B	Vein lifter	✓	✓	✓	✓
1	C	Puncture needle	18 G x 70 mm	20 G x 50 mm	18 G x 70 mm	18 G x 70 mm
1		Introcan needle		20 G x 32 mm		
1	E	J guide wire with dispenser	0.035" x 150 cm	0.025" x 50 cm	0.035" x 50 cm	0.035" x 70 cm
1	F	ECG cable				✓
1	G	Tear-away introducer/Dilator	L 180/140 mm	L 80/50 mm	L 180/140 mm	180/140 mm
1	H	Tunnelling rod	✓	✓	✓	✓
1	I	Omnifix luer syringe	10 mL	10 mL	10 mL	10 mL
1	J	Winged Surecan® needle	22 G x 15 mm	22 G x 15 mm	22 G x 15 mm	20 G x 20 mm

		Implantation technique	
			Seldinger
Pieces		Kit designation	Kit 7
1	A	Straight Surecan®	22G x 30mm
1	K	Vein lifter	✓
1	L	Rinsing Hub	✓
1	M	Safecan® Safety	18G x 70mm
1	E	J Guide Wire with Dispenser	0.035" x 50cm
1	G	Tear-away Introducer	180/140mm
1	N	Tunnelling Rod	✓
1	I	Omnifix® Luer Syringe	10 mL
1	D	Surecan® Safety II	20 G x 20 mm

SEPARATE ACCESSORY KITS

		Reference	4430483	4430484	4430492	4430493
Pieces		Kit designation	AP 6F	AP 7F	AP 9F	AP 16F
1	C	Puncture needle	20 G x 50 mm Seldinger	18 G x 70 mm Seldinger	18 G x 70 mm Seldinger	18 G x 70 mm Seldinger
1		Introcan needle	20 G x 32 mm			
1	E	J guide wire with dispenser	0.025" x 50 cm	0.035" x 50 cm	0.035" x 50 cm	0.035" x 40 cm
1	G	Tear-away introducer/Dilator	6F, short (80/50 mm)	7F x180/140 mm	9F x180/140 mm	16F with dilator 12F-14F
1	H	Tunnelling rod	✓	✓	✓	✓
1	B	Vein lifter	✓	✓	✓	
1	I	Omnifix luer syringe	10 mL	10 mL	10 mL	10 mL
1	J	Winged Surecan® needle	22 G x 15 mm	20 G x 20 mm	20 G x 20 mm	19 G x 25 mm

Aesculap – a B. Braun company

B. Braun Australia Pty Ltd | Bella Vista NSW | Tel.1800 251 705 | info.au@bbraun.com | www.bbraun.com.au
B. Braun New Zealand | Customer Care 0800 657 775 | Fax (09) 526 0782 | www.bbraun.co.nz

BANZ AE E0384 05/18 | ©2018 B. Braun Australia